



Technical Data

Power supply	Machine: 24V d.c. - 5,5 Amp. - 130W Power pack: 90/264V a.c. - 50/60Hz - 220W - MEANWELL GS220A24-R7B
Cutter motor (flat cuts)	24V d.c.
Cutter motor (dimple/laser cuts)	24V d.c.
Prismatic cutter (flat cuts)	01F, in HSS super rapid steel, TiCN coated
Cutter (dimple cuts)	01D, in HSS super rapid steel
Cutter (laser cuts)	01LW, in carbide, AlCrN coated
Tool speed	Prismatic Cutter :1500 rpm Cutter (dimple/laser cuts):11800 rpm
Movements	on 3 axes (with special bushes) driven by step motors (on rectified roller guides)
Clamp (flat cuts)	01V, removable, with 4 universal sides for holding flat, vehicle and cruciform keys
Clamp (dimple/laser cuts)	01R, removable and provided with interchangeable jaws (01J and 02J)
Runs	X axis: 30 mm, Y axis: 50 mm, Z axis: 27 mm
Dimensions	width: 318 mm, depth: 413 mm, height with tablet and stand: 522 mm (without tablet and stand: 340 mm)
Weight	20 Kg

Futura Light



Faster cutting cycle



Integrated tablet



2 in 1 machine



Compact and lightweight

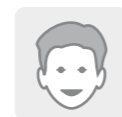

User-friendly software



Immediate process control via the lights



Silca quality and design



FUTURA LIGHT



Futura Light

Futura Light is an electronic key cutting machine able to duplicate all types of residential and automotive keys

Futura Light is a unique electronic key cutting machine combining two cutting stations in one user-friendly device. Ideal for inexperienced key cutters thanks to the software-guided procedures, this lightweight and compact machine is also perfect for professional locksmiths offering a roadside service. Now even faster than before, Futura Light stands out for the quality of its key cuts, its small footprint and its access to the widest key database available on the market via the integrated tablet.

Futura Light

Futura Light is the electronic key cutting machine for residential and vehicle flat, cruciform, laser and dimple keys.

CE Futura Pro has been designed and manufactured in conformity with CE mark European standards.

Exclusive double cutting station

Futura Light is unique in having two cutting stations so flat, cruciform, laser and dimple keys, both residential and automotive, can all be cut using a single machine. The wide range of optional accessories available further increases the machine's cutting capabilities allowing you to duplicate almost any residential and vehicle key on the market.

Practical and easy to operate

Futura Light is controlled by a removable, 10" touch-screen tablet, which guides the user step-by-step in all key cutting operations (for example in selecting the correct key profile of a cylinder key, the make, model and year for vehicle keys, in the choice of the right cutter, clamp, etc.). The tablet integrates Silca

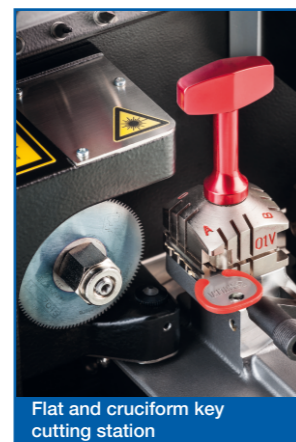

Flat and cruciform key cutting station



Laser and dimple key cutting station

Software's main functions and data, including an extensive range of data cards and code tables for flat, cruciform, laser and dimple keys.

Immediate process control

The colour-changing LED lights help the key cutter to immediately see the process status:

- White: the machine is ready to proceed;

Flat and cruciform key cutting station - Copy by code and copy by original

- Decoding via optical reader.
- Copy by original function.
- Resistant-to-wear prismatic cutter.
- Guided calibration of the cutting station
- Four-sided clamp with fast rotating solution.
- New, ergonomic clamp handle to easily tighten the key securely in place.
- All automotive keys and most residential keys cut in one cycle

Laser & dimple key cutting station

- Decoding by electric contact.
- Pull-out tracer point.
- Clamp with easy-change, interchangeable jaws means more cost-effective use of accessories and speedier installation.
- Existing Futura jaws are fully compatible with the new Futura Pro clamp whilst the easy-change jaws are also compatible with the Silca Triax Pro.
- Automatic calibration of the decoder and the cutting station.

- Yellow: the machine is cutting a key;
- Green : the key cutting is complete.
- Blue : the software is ready / software update is ready.

Faster cutting cycles

Futura Light features faster cutting cycles thanks to a motor that delivers up to three times more power and cutters that reach speeds of 1500 rpm for flat keys and 11800 rpm for laser and dimple keys. A new tablet together with upgraded electronics deliver both faster response times and an all-round improvement in the machine performance.

Improved hardware and connectivity with 2 USB ports

All exposed screws are made of stainless steel for better resistance to wear and a longer life. The machine is



Utensil area on top of the machine

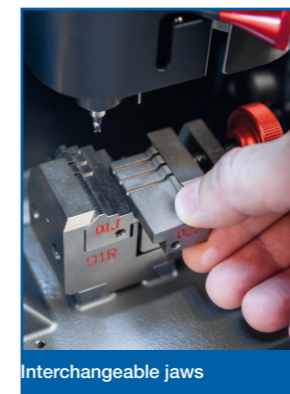

Interchangeable jaws

equipped with 2 USB ports at the rear: one for the tablet battery charger and one for the tethering connection so the Futura Light and tablet remain connected and operational even when the Wi-Fi connection is lost or unstable. The second USB port can also be used to connect the USB flash drive supplied with Futura Light to import code tables or machine software updates.

Space-saving and portable solution

Futura Light is compact, lightweight and easy to carry.



The tablet stand attaches to the top of the machine and can be tilted. The tablet stand can also be placed on a bench or table next to the machine

Optional accessories

A number of optional clamps, jaws, cutters and adapters allow forcutting a wide range of special keys, including: Abus®, Assa®, CES®, Cisa®, Dom®, Iseo®, Kaba®, Keso®, Mul.T.Lock®, Pfaffenhain®, Securemme®, Winkhaus®, BMW®, Citroën®, Ford®, Huf® and Mercedes® type keys and tubular

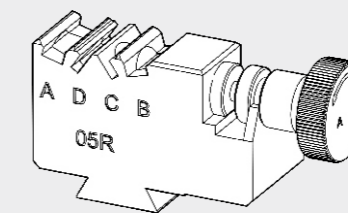

for Kaba® ExperT type keys

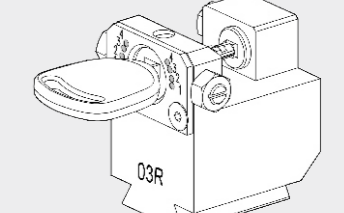

03R clamp for Ford® (Valeo® and Tibbe®) type keys

New software features

Shortcut function for vehicle key cutting code searches

Searching for the right vehicle key cutting code is now easier and quicker with the card search shortcut function. Just input the first letters and the software will prompt the make and model you're looking for, so you don't have to manually enter the entire field.

Key cut preview

The preview allows the key cutter to check and correct the cut for a worn key. This function is now available also for laser keys.

Guided updating procedure

Keeping abreast of Futura Light's continuous upgrades has become easier with the new guided updating procedure. The software leads the user step-by-step through all the operations required for updating the machine (both via Wi-Fi and via web with Silca Remote Service).

Faster switch on

The machine turns on quickly thanks to the new upgraded electronics

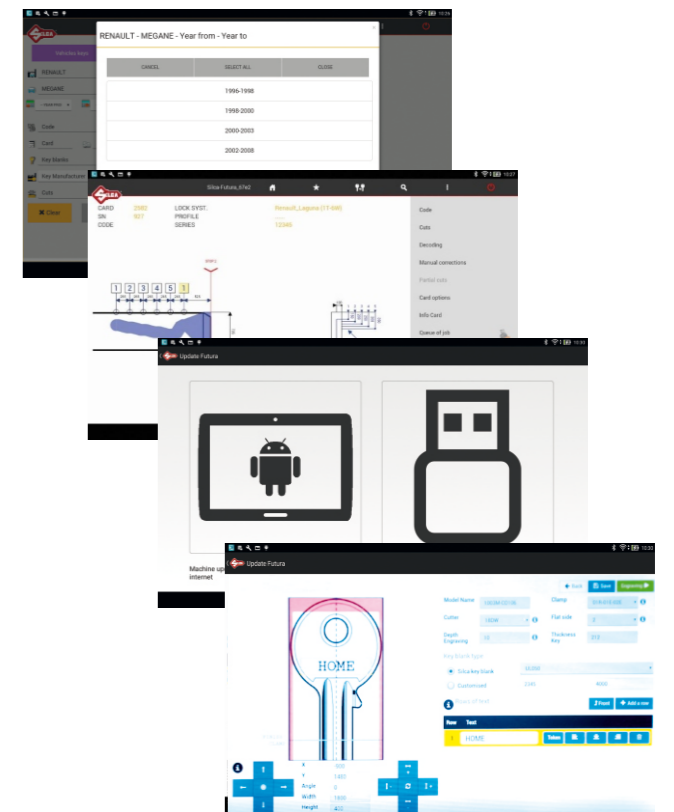

In compliance with current regulations relating to industrial property, we hereby state that the trade-marks or trade names mentioned in this document are the exclusive property of authorized manufacturers of locks and users. Said trade-marks or trade names are mentioned only for the purposes of information so that any lock for which our keys are made can be readily identified. This document is reserved exclusively for professional key cutters who use Silca products. / All information and illustrations in this document are for guidance only. Silca reserves the right to alter products designs, dimensions or info to improve the products quality. The contents of this document are fully protected by Copyright and may not be copied or reproduced in any form, without written permission from Silca S.p.A. Any controversy shall be settled by the Courts of Justice where the company has its headquarters, with express exclusion of any other court.